

MCKELLAR & ASSOCIATES
ARCHITECTS

Post Office Box 1076, Mt Pleasant, SC 29465
Phone 843/884.9085 Fax 843/884.9058

1	REVISION 1	05.30.06
1	ADDENDUM 1	1/27/06
NO	REVISION	DATE

OFFICES AT BELLE HALL

LONG POINT ROAD
MT. PLEASANT, SC

BUILDINGS 1 & 2
ENLARGED STAIR C PLAN
/ELEVATOR SHAFT

A302

DESIGNED	CLS/JLC	SHEET	OF
DRAWN	DL/JLC	SCALE	1/4"=1'-0"
REVIEWED	AWJ	PROJECT NO	200548.10
CHECKED	AMM	DATE	1.8.06

REVISION 1

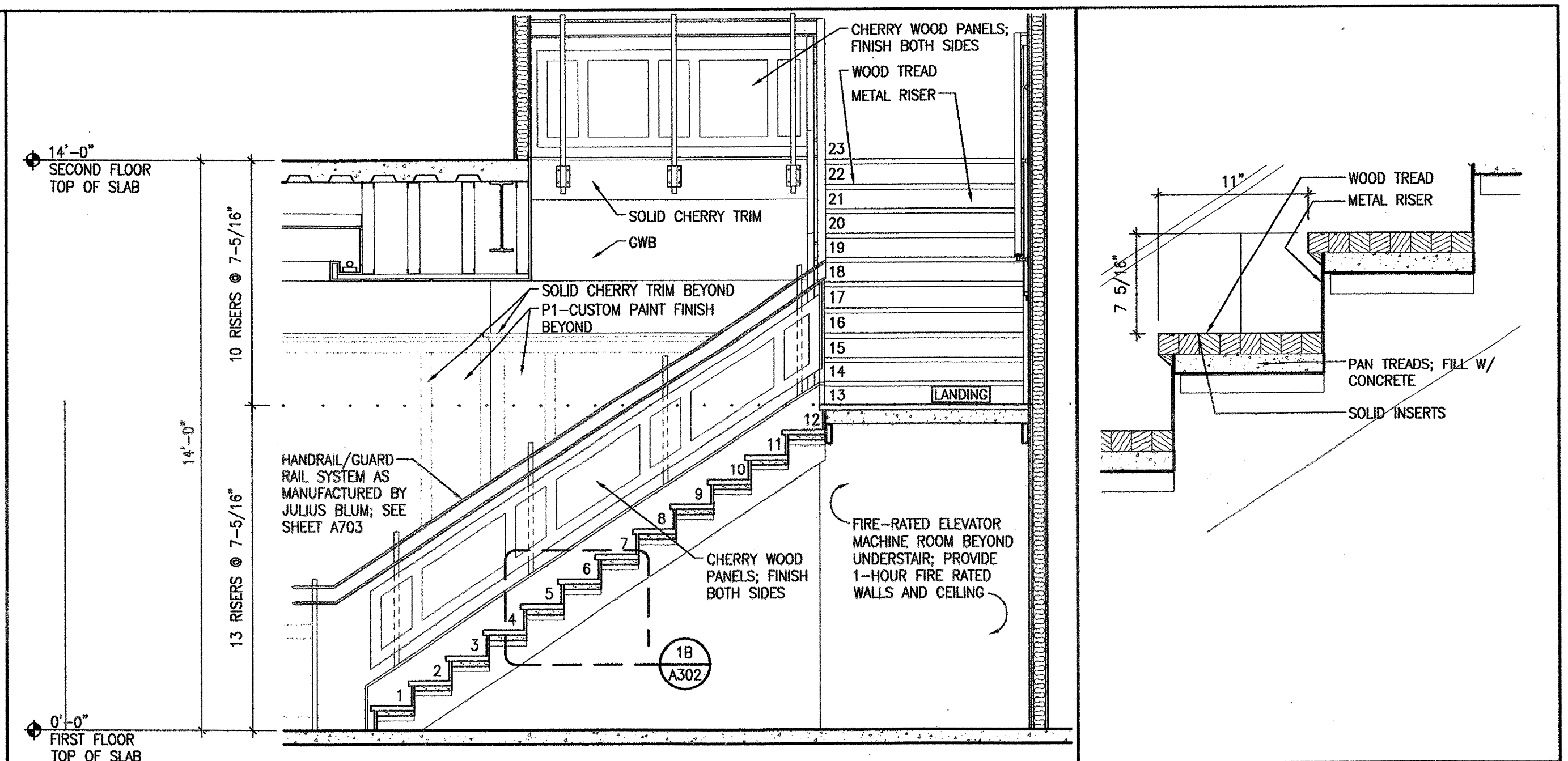

1A	SECTION	1B	DETAIL
3/8"=1'-0"	@ STAIR C	1 1/2"=1'-0"	@ STAIR C

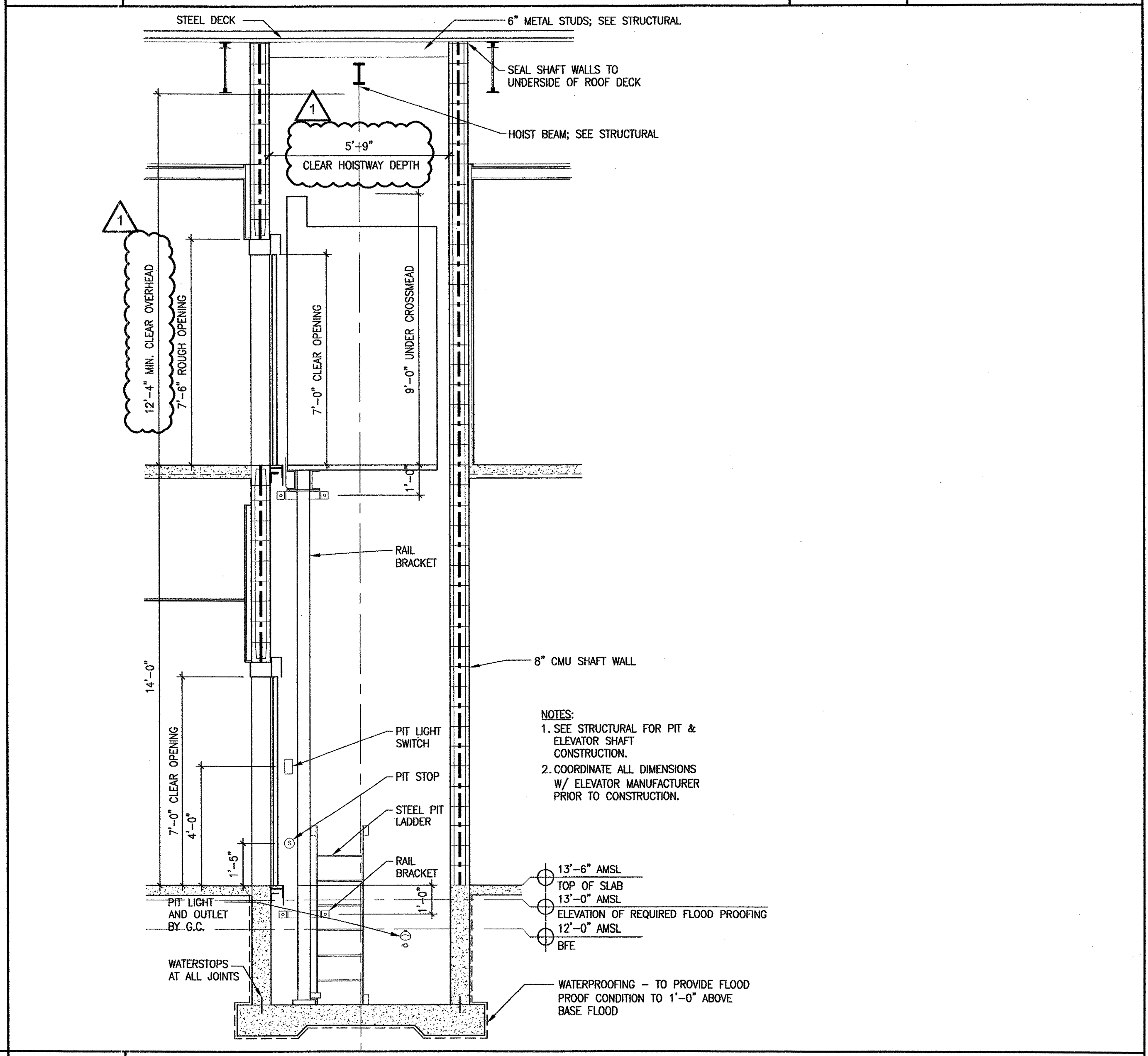

2	SECTION
3/8"=1'-0"	@ ELEVATOR SHAFT

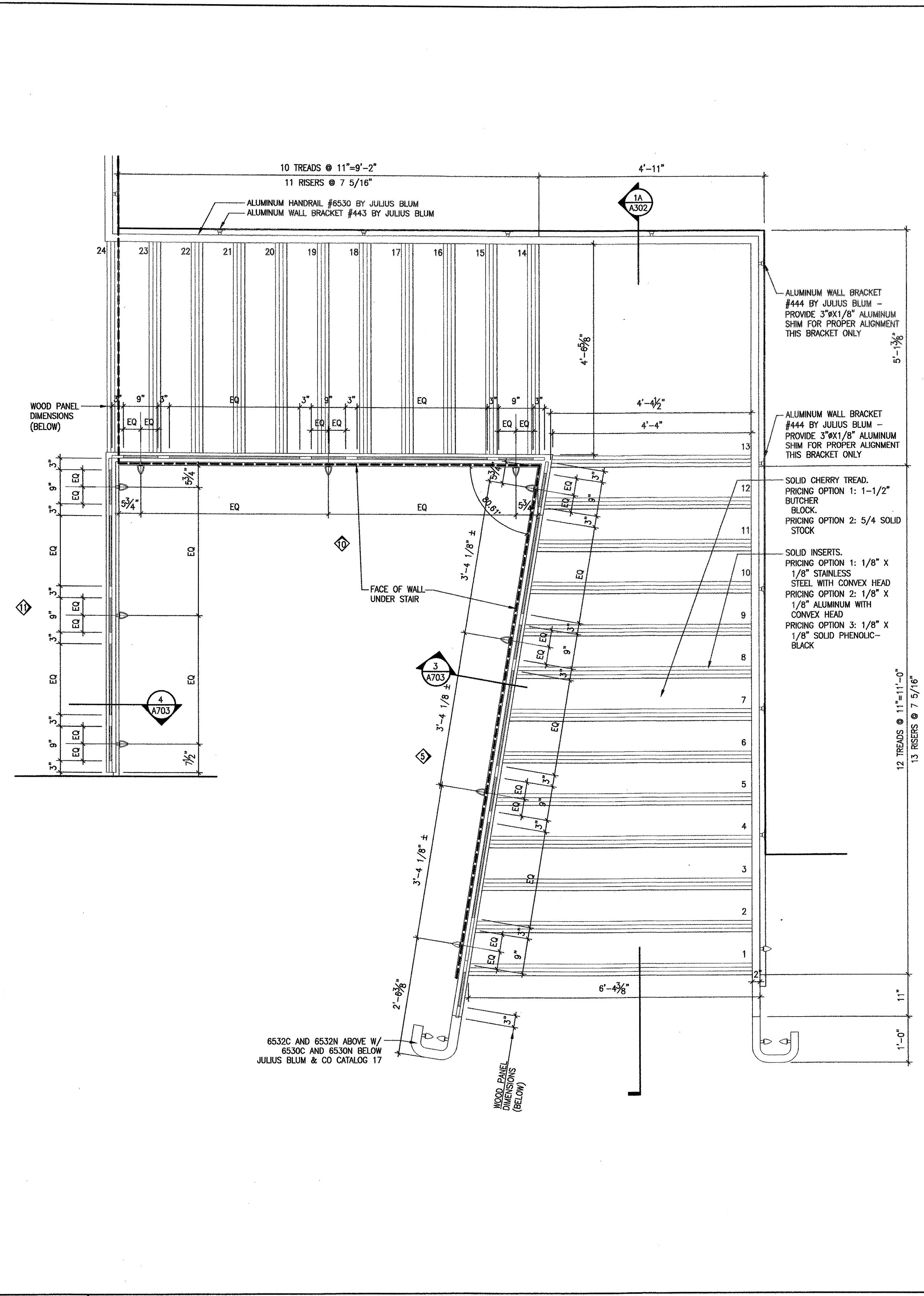

1	STAIR C ENLARGED PLAN
3/4"=1'-0"	

This drawing is the property of McKellar & Associates. Unauthorized use of any kind, including on other projects, is prohibited. May 30, 2006

Drawing name: P:\2005\proj\200548.10 - Belle Hall Offices\MCK\A302.dwg May 25, 2006 - 1:48pm